

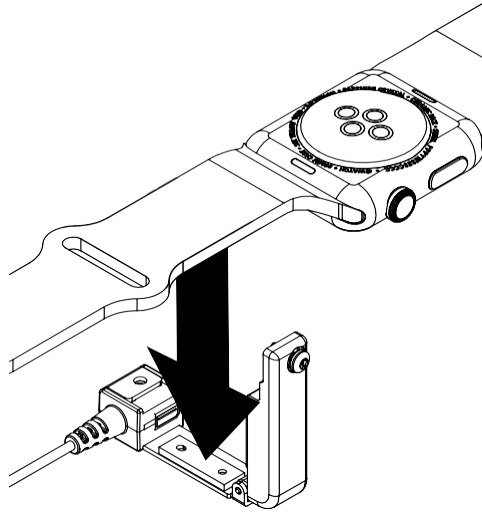

### 14a Universal Flex Sensor Installation:

Place the back band of the wearable into the open band clamp.



14b Plug the universal flex sensor into the port on the inside of the band clamp over the wearable.

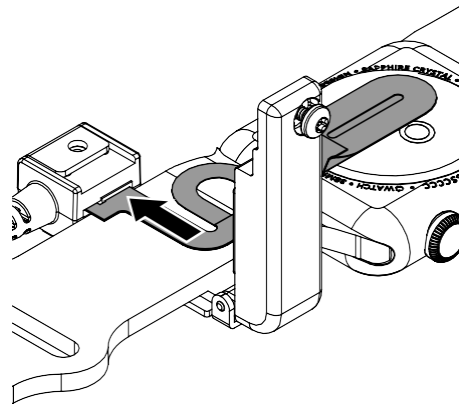

14c Adjust the wearable so that the area between the 2 white lines on the flex sensor (the shaded area in the below image) will sit over the "hinge" area (the area where the band connects to the watch body) of the wearable.

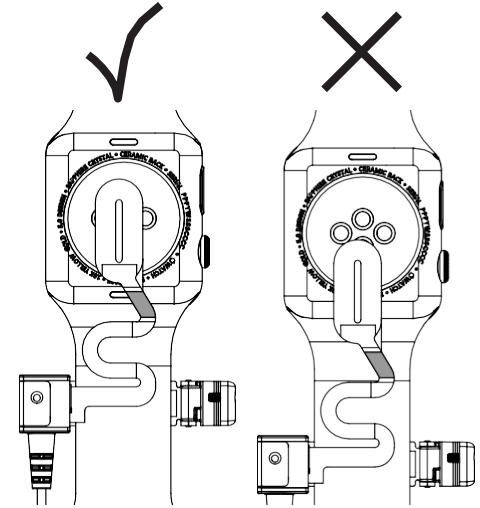

14d Peel the liner from the adhesive portion of the flex sensor.

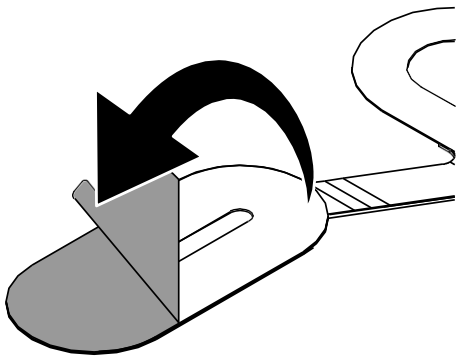

14e Press the flex adhesive against the bottom of the wearable for at least 10 seconds. Ensure that all of the oval is adhered to the wearable and that no gap is visible.

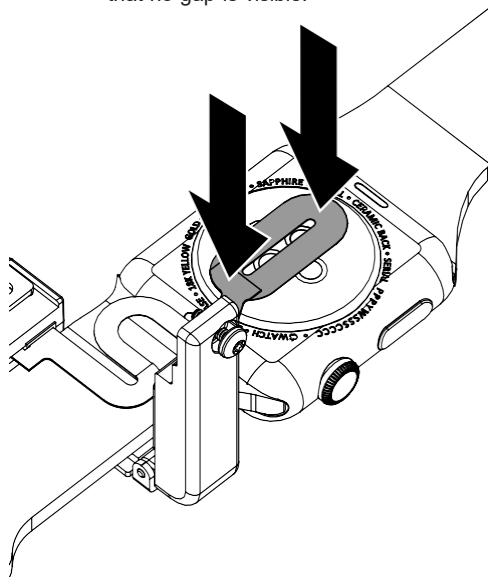

15 Close the band clamp over the watch band and flex sensor.

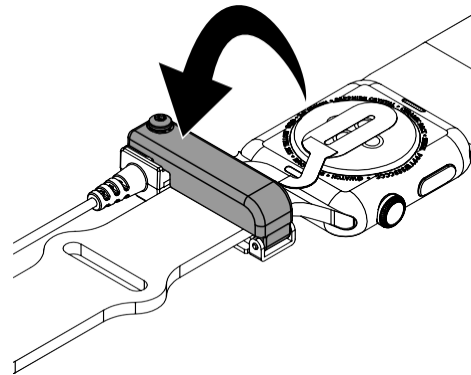

16 Press down on the band clamp and use a TT8 bit to tighten the screw in the band clamp. Do NOT overtighten.

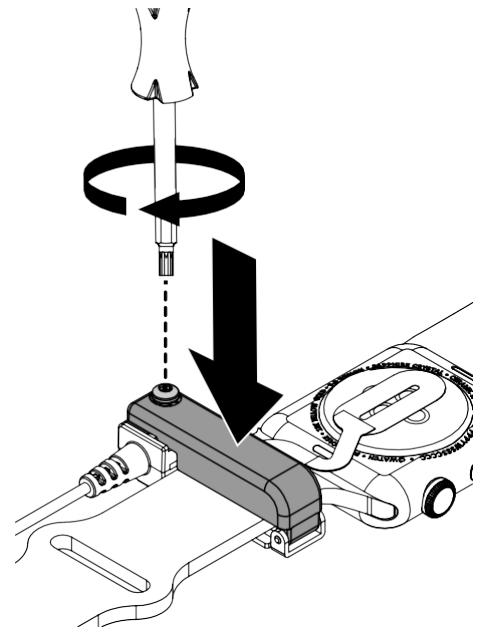

17 Place the wearable onto the cradle.

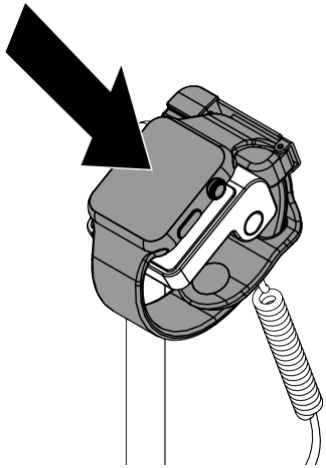

18 Plug the stand's power cable into a Zips alarm unit, S2865 power/alarm box, OnePOD aux port.

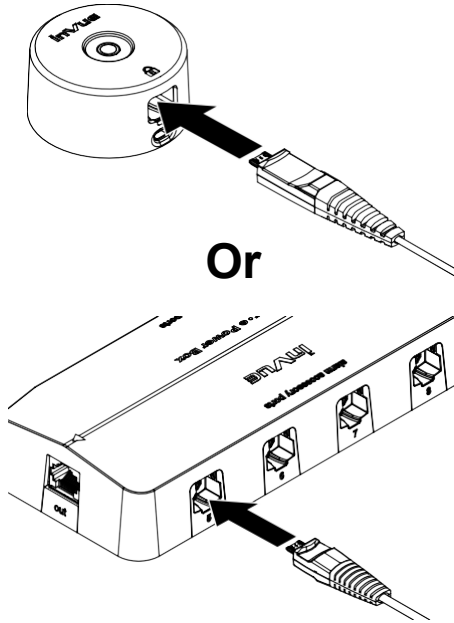

SD0694 Rev2 12/02/19

**invue**

[www.invue.com](http://www.invue.com)

NA / LATAM // 704.752.6513 • 888.55.INVUE

EMEA // +31.23.8900150

APAC // +852.3127.6811

© 2019 InVue Security Products Inc. All rights reserved.  
InVue is a registered trademark of InVue Security Products.